

THE REVISION STATUS OF ALL SHEETS OF THIS DRAWING IS THE SAME AS SHEET 1

LTR	DESCRIPTION	DATE	BY
-	Released	12/7/97	JCL
A	Updated	8/17/07	JCL

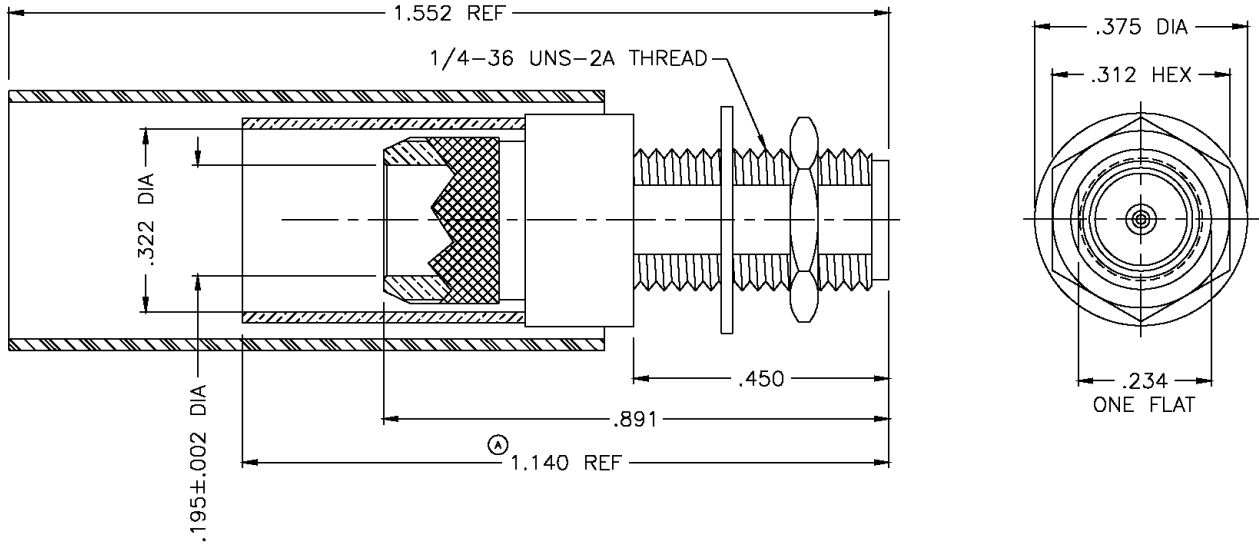

I. MATERIALS & FINISHES

- center contact: Gold Plated Beryllium Copper
- outer contact: Passivated Stainless Steel
- body: Passivated Stainless Steel
- crimp sleeve: Tin Plated Copper
- dielectric: Teflon® PTFE
- gasket: Silicone Rubber
- shrink sleeve: Adhesive Lined Polyolefin
- attachment: braid crimp (.324"hex)

II. ELECTRICAL PROPERTIES

- impedance: 50 ohms
- working voltage: 500 vrms (max)
- vswr: 1.25:1 (max) up to 2.5 GHz
- insertion loss: 0.10 x √Fghz



Australian Representatives
ROJONE, PTY LTD.
 Tel: 02 9829 1555
 E: sales@rojone.com.au
 www.rojone.com.au

Unless otherwise specified, dimensions are in inches. Tolerances are applicable when specified.

These drawings and specifications contain proprietary information which is the property of Times Microwave Systems.

Approvals		
Drawn	JCL	12/7/97



TIMES MICROWAVE SYSTEMS
 Wallingford, CT 06492
 (203) 949-8400; (203) 949-8423.Fax
 www.timesmicrowave.com

TC-300-SF-BH

Type-SMA female Bulkhead
for LMR-300 Cable

Size	CAGE CODE	Drawing No.:
A	68999	3190-590

Scale: NA	Rev. (A)	Sheet: 1 of 1
-----------	----------	---------------