

**NOTICE OF PROPRIETARY RIGHTS** THIS DOCUMENT CONTAINS CONFIDENTIAL TECHNICAL DATA, INCLUDING TRADE SECRETS, PROPRIETARY TO TIMES MICROWAVE SYSTEMS. DISCLOSURE OF THIS DATA IS EXPRESSLY CONDITIONED UPON YOUR ASSENT THAT ITS USE IS LIMITED TO USE WITHIN YOUR COMPANY ONLY. ANY OTHER USE IS STRICTLY PROHIBITED WITHOUT THE PRIOR WRITTEN CONSENT OF TIMES MICROWAVE SYSTEMS.

SYM	REVISION DESCRIPTION	DFTM	DATE	APPD	DATE
-	RELEASED FOR PRODUCTION	J. C. L.	5/2/03	J. C. L.	5/2/03
A	CHANGED PER CDC #35986	D. J. H.	8/31/12	J. D. B.	9/5/12

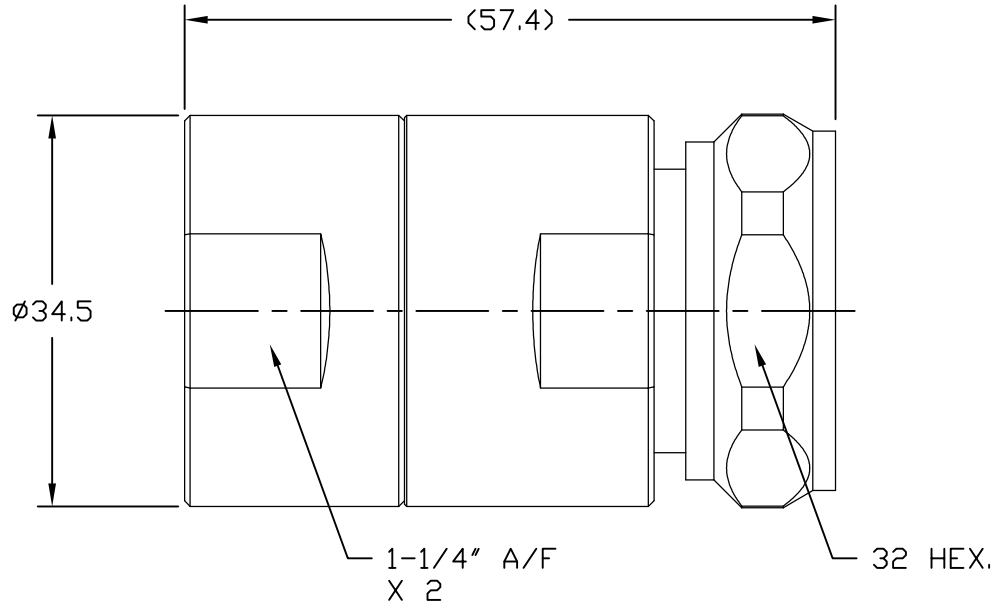

Reference standard IEC60169-4

I. Electric Performance

Nominal Impedance( $\Omega$ ): 50  
 Frequency Range: DC-3GHz  
 VSWR:  $\leq 1.15$   
 Insert Loss (dB):  $\leq 0.05$   
 Insulation resistance(M $\Omega$ )  $\geq 10000$   
 Proof voltage(V) 4000  
 Conductor resistance(m $\Omega$ ) outer conductor <0.2  
 inner conductor <0.8

II. Mechanical Performance

Nut torque 25N.m  
 (Nut)Whorl pull 1000N  
 Tensile Force (cable-connector) 500N  
 Torsion (cable-connector) 5N.m

III. Material and plating :

Inner conductor Brass Plating Ag 5um  
 Outer conductor Brass Plating Copper-tin-zinc 2um  
 Nut Brass Plating Ni 5um  
 Gasket Silicone rubber  
 Insulator PTFE

IV. Environment

Temp. range -55 $^{\circ}$ C~+155 $^{\circ}$ C  
 Weather standard IEC 60068 55 / 155/ 56  
 Thermal shock US MIL-STD 202,Meth.107,Cond.B  
 Vibration US MIL-STD 202,Meth.204,Cond.B  
 Shock US MIL-STD 202,Meth.213,Cond.I  
 Waterproofing standard IP67

V. Assembly: inner and outer conductor installed

VI. ROHS Compliant.

**Australian Representatives**  
**ROJONE, PTY LTD.**  
 Tel: 02 9829 1555  
 E: sales@rojone.com.au  
 www.rojone.com.au

MATERIAL:	UNLESS OTHERWISE SPECIFIED	DFTM. J. C. L.	TIMES MICROWAVE SYSTEMS
	ALL DIMENSIONS ARE IN mm MACHINED SURFACES FINISH N/A RMS MAX. REMOVE ALL BURRS N/A MAX. BREAK MACHINE CORNERS N/A MAX. FILLET R. TOLERANCES ON DECIMALS . XX $\pm$ N/A . XXX $\pm$ N/A ANGLES $\pm 1^{\circ}$ FRACTIONS $\pm$ N/A	DATE 5/2/03	
USED ON: 1-0		CHKD. J. C. L.	<b>EZ-900-716MC-2</b> 2 PIECE 7-16 DIN MALE FOR LMR-900 CABLE
		DATE 5/2/03	
SCALE: N/A	DWG. SIZE A	APPD. J. C. L.	
DO NOT SCALE DRAWING	CODE IDENT 68999	DATE 5/2/03	SHT 1 of 1   SD3190-1641   REV A