

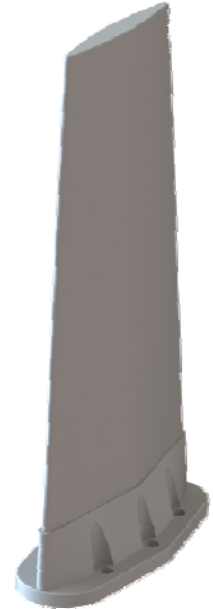

21-50-16
UHF / L-Band
Airborne Blade Antenna
225 to 450 MHz & 960 to 1220 MHz

FEATURES

- **Covers EPLRS/UHF Com and TACAN/IFF Bands**
- **High Isolation provided by external diplexer**
- **High Strength, Lightweight Composite Blade**
- **Low Side Area, Low Drag**
- **Single 'N' Type Connector**
- **Drop-on replacement for AT-256, NSN's 5985-01-418-6105 and 5985-01-331-8710**
- **Environmental Performance to MIL-STD-810**



The 21-50-16 is a high performance combined UHF/L-band airborne blade antenna suitable for fixed and rotary wing aircraft.

Construction is from a one piece glass loaded thermoplastic blade molding intimately bonded onto an aluminum alloy base plate which provides RF grounding and attachment to airframe via 6 mounting holes drilled to the same pattern as the AT-256 UHF antenna.

Integral radiating elements are shaped in such a way as to produce minimum VSWR in both UHF and L-band and also to optimize radiation pattern at L-band where the antenna would otherwise be electrically too long.

The antenna assembly is sealed by closed cell foam and normally finished in lusterless grey urethane paint.

The 21-50-16 can be used with CAL diplexer P/N 21-80-16.

Cooper Antennas Ltd for non-USA customers
Thames Industrial Estate, Unit K, Fieldhouse Lane,
Buckinghamshire SL7 1TB, UK
Tel: +44 (0) 1628 482 360
Email: sales@cooperantennas.com
www.cooperantennas.com

Aviatech Corporation for USA customers
3001 Lake Creek Drive, Highland Village
Texas 75077, USA
Tel: +1 817-430-4784
Email: sales@aviatechcorp.com
www.aviatechcorp.com

Cooper Antennas Ltd is Accredited to: ISO9001, AS9100, ISO14001 and MAA Approved

SPECIFICATIONS

Cooper Antennas Model 21-50-16 Airborne Blade Antenna

ELECTRICAL

Frequency	UHF :	225 to 450 MHz
	L-Band :	960 to 1220 MHz
Gain	UHF :	≥ +2 dBi
	L-Band :	≥ +1 dBi
VSWR	225-240 MHz	≤ 2.5:1
	240-450 MHz	≤ 2.25:1
	960-1220 MHz	≤ 1.8:1
Impedance (nominal)	50 Ohms	
Power	UHF :	50 Watts CW
	L-Band :	100 Watts CW 2KW Peak
Polarization	Vertical	
Radiation	Omni directional in azimuth	
Antenna RF Connector	N Female	

MECHANICAL

Antenna Shell Type	Glass loaded thermoplastic molded blade
Height	9 inches (228mm)
Weight	1 lb (0.45kg)
Side Loading	≥ 6 psi ultimate
Base Plate Shape	Diamond shape
Fixing Holes	6 x Ø 0.205inch (5.2mm) holes, counter bored Ø 0.39 inches (9.9mm)

FINISH

Antenna	Urethane Lusterless Grey
---------	--------------------------

Other finish options are available. Please specify finish required when ordering.

Note: Cooper Antennas Ltd has a policy of continuous product improvement and data herein is therefore subject to change.
Please check with Cooper Antennas Ltd that this data sheet is at latest issue before initiating contract activity.